



P3CARS.COM
PRECISION • PASSION • PERFORMANCE

Please download the latest copy of this document from www.p3cars.com/install

BMW 335 Vent Assembly



1

Unclip the 3 top clips of the vent as shown. You can simply put pressure between the clips and pull forward.



2

Unclip the front clip on the right side of the vent and flex the front of the vent forward.



3

Pull down and forward until the bottom clips release and the entire front cover of the vent will come off.

WARRANTY & LIABILITY:

Neither P3 Cars, nor its dealers or agents shall be liable in any way, for any damage, loss, injury or other claims, resulting from the installation or use of this product. By purchasing or installing this product, you assume all liability of any kind connected with the use and/or application of this product. If you are unsure that you can safely install and use this product, consult a qualified installer or mechanic. The warranty on this product covers only the product itself for a period of 6 months from the date of purchase, and it will be at our discretion to repair or replace the affected parts. No user serviceable parts inside. Warranty will be voided if product shows physical damage.



4a

Unclip and remove the vent slats from the vent.

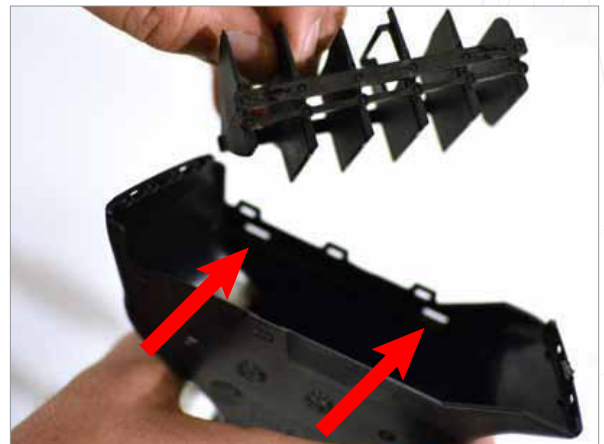

4b

Also unclip the inner vent slats from the tube. You can flex the vent vertically and release them.



P3CARS.COM
PRECISION • PASSION • PERFORMANCE

Please download the latest copy of this document from www.p3cars.com/install

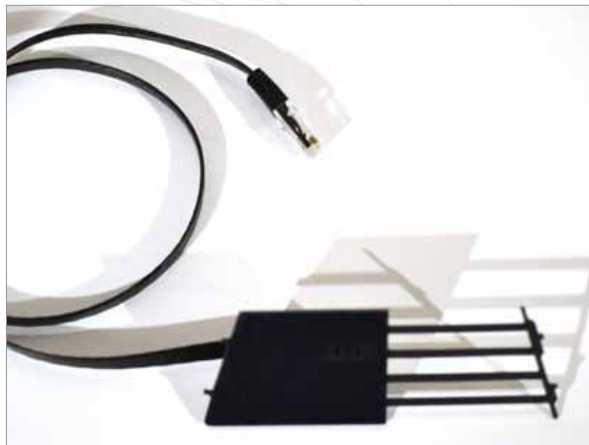

5a Feed the cable from the display through the vent and out the rear left side.



5b The cable is flat as not to interfere with the vent functions and exit through the back of the vent without any cutting.



6 Insert the display into the vent tube and secure its aluminum tabs into the 4 slots, 2 on each side. Feed the excess cable out the rear of the vent.



WARRANTY & LIABILITY:

Neither P3 Cars, nor its dealers or agents shall be liable in any way, for any damage, loss, injury or other claims, resulting from the installation or use of this product. By purchasing or installing this product, you assume all liability of any kind connected with the use and/or application of this product. If you are unsure that you can safely install and use this product, consult a qualified installer or mechanic. The warranty on this product covers only the product itself for a period of 6 months from the date of purchase, and it will be at our discretion to repair or replace the affected parts. No user serviceable parts inside. Warranty will be voided if product shows physical damage.



7 Re-attach the vent face. **BOTTOM FIRST**, after clipping the bottom side, then clip in the top.





P3CARS.COM
PRECISION • PASSION • PERFORMANCE

Please download the latest
copy of this document from
www.p3cars.com/install



8

Installation complete!

Please refer to the [gauge usage and configuration guide](#) for an explanation of features. If you have additional questions, email us at support@p3cars.com

WARRANTY & LIABILITY:

Neither P3 Cars, nor its dealers or agents shall be liable in any way, for any damage, loss, injury or other claims, resulting from the installation or use of this product. By purchasing or installing this product, you assume all liability of any kind connected with the use and/or application of this product. If you are unsure that you can safely install and use this product, consult a qualified installer or mechanic. The warranty on this product covers only the product itself for a period of 6 months from the date of purchase, and it will be at our discretion to repair or replace the affected parts. No user serviceable parts inside. Warranty will be voided if product shows physical damage.